

**Front**

Refer to Notices on pages 28-29.

**NOTICE:** Do not tow with sling-type or wheel-lift equipment or rear bumper valance damage will occur. Use carrier equipment only. Additional ramping may be required. Use four nylon tie-down straps.

**NOTICE:** Do not attach winch cables, chains, J-hooks, T-hooks or R-hooks to suspension components when using carrier equipment. They will damage drive system and suspension components. Always use nylon tie-down straps.

**USING NYLON TIE-DOWN STRAPS:** Route the front nylon tie-down straps around the lower control arms near the front tires (on both sides of the vehicle).

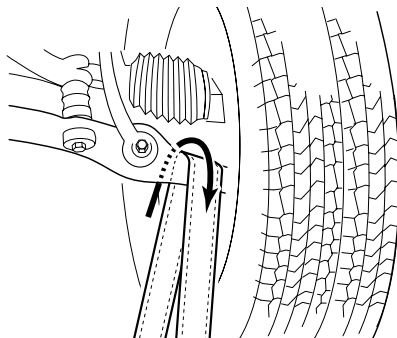

**USING CHAINLESS TIE-DOWNS (NYLON TIRE BASKETS):** Chainless tie downs (nylon tire baskets) are an acceptable alternative to the nylon tie-down strap procedure.

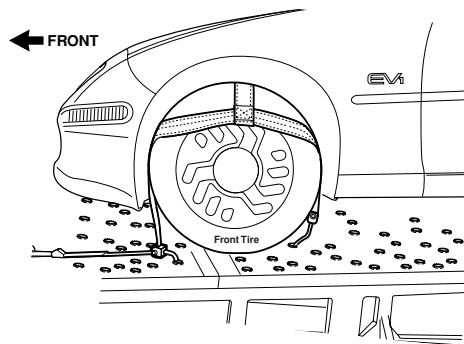

**FRONT CONNECTION PROCEDURE**

1. Enter Run/Lock Shifter Assembly (RSA) key code, then push the Run button.
2. Press the brake pedal, and place the shifter lever in Neutral (N). This procedure will release the park brake.
3. Once the shifter lever is in Neutral (N), place the keypad in OFF mode.

**IMPORTANT:** To release the parking brake with keypad in LOCK mode and the shift lever in Park (P):

1. Press the brake pedal.
2. While brake pedal is pressed, push the park brake apply/release button (located on the left side of the instrument panel).

If the vehicle has no 12 volt auxiliary power and the shifter is in Park (P) and the parking brake is applied, perform the Battery Recovery procedure, as follows:

1. Momentarily press and release the battery recovery button (located under the instrument panel on passenger's side of car).
2. Wait 30 seconds.
3. Press and hold the battery recovery button for three seconds, then release the button.
4. Enter Run/Lock Shifter Assembly (RSA) keycode and push the "Run" button.

If the voltage is restored, press the brake pedal and place the shifter lever in the Neutral (N). The parking brake will be automatically released. Once the shifter lever is in Neutral (N), place the keypad in OFF mode. If voltage is NOT restored, apply liquid soap and water solution to the pavement and the carrier equipment bed.

Rear

Refer to Notices on pages 28-29.

**NOTICE:** Do not tow with sling-type or wheel-lift equipment or rear bumper valance damage will occur. Use carrier equipment only. Additional ramping may be required. Use four nylon tie-down straps.

**NOTICE:** The rear suspension track bar will be damaged if used as an attachment point. Do not route the nylon strap around the rear suspension track bar.

**NOTICE:** Do not attach winch cables, chains, J-hooks, T-hooks or R-hooks to suspension components when using carrier equipment. They will damage drive system and suspension components. Always use nylon tie-down straps.

**USING NYLON TIE-DOWN STRAPS:** Route the rear nylon tie-down straps up through the spring mount holes at the rear axle, then forward through the lowest coil spring opening and back around the axle.

If a rear nylon tie-down strap is routed through a coil spring opening higher than the lowest opening, the coil spring may become dislodged from the upper spring during towing. Make sure both tie-down straps are routed through the lowest coil spring openings.

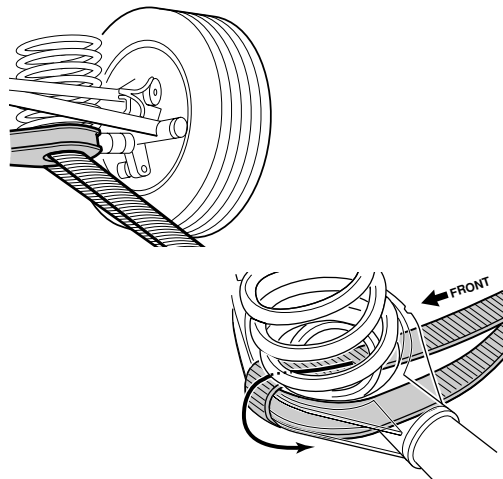

**USING CHAINLESS TIE-DOWNS (NYLON TIRE BASKETS):**

Chainless tie-downs (nylon tire baskets) are an acceptable alternative to the nylon tie-down strap procedure. In order to access the rear tire, the rear wheel opening covers must be removed.

Two locking retainers attach each wheel opening cover to the vehicle. The locking retainers are on the inboard side of the cover at the front and rear edge of the wheel opening. To remove a cover:

1. Turn the two locking retainers one-quarter turn to the vertical position.
2. Pull out and lower the cover from the wheel opening.

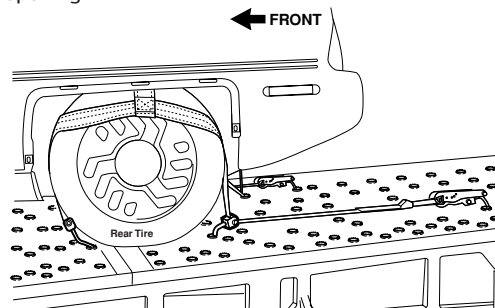

**REAR CONNECTION PROCEDURE**

1. Enter the Run/Lock Shifter Assembly (RSA) keycode, then push the Run button.
2. Press the brake pedal, and place the shifter lever in Neutral (N). This procedure will release the parking brake.
3. Once the shifter lever is in Neutral (N), place the keypad in OFF mode.

IMPORTANT: To release the parking brake with keypad in LOCK mode and the shift lever in Park (P):

1. Press the brake pedal.
2. While brake pedal is pressed, push the park brake apply/release button (located on the left side of the instrument panel).

# Towing Recommendations and Guidelines

The following notices describe precautions necessary to prevent damage to towed vehicles. Refer and adhere to these notices whenever towing a GM vehicle. In addition to the general notices below, individual vehicles may require additional precautions due to the vehicle's design, equipment, or other unique features. These vehicle-specific notices are included on the appropriate vehicle page. They should be adhered to in addition to the notices below. The following pages also contain guidelines for vehicle content features that affect towing. These should also be adhered to, as applicable, in addition to all applicable notices. **Failure to follow these notices and guidelines may result in damage to the customer's vehicle.**

These instructions apply to vehicles with standard equipment only. Any optional equipment such as campers, special bodies, front mounted spare tires, trailer hitches, etc. must be given due consideration.

## Front Tow Notices

**NOTICE:** Towing on a vehicle's drive wheels should be avoided, if possible. When towing on the drive wheels, maximum speed and distance limitations must be adhered to and/or a towing dolly may need to be used.

**NOTICE:** When towing most AWD vehicles, a towing dolly must be used on the ground wheels or vehicle damage will occur.

**NOTICE:** Do not tow with sling-type equipment or fascia/fog lamp damage will occur. Use wheel-lift or carrier equipment. Additional ramping may be required for car-carrier equipment. Use safety chains and wheel straps.

**NOTICE:** Towing a vehicle over rough surfaces could damage the vehicle. Damage can occur from vehicle-to-ground or vehicle-to-wheel-lift equipment contact. To help avoid damage, install a towing dolly and raise vehicle until adequate clearance is obtained between the ground and/or wheel-lift equipment.

**NOTICE:** Do not attach winch cables or J-hooks to suspension components when using carrier equipment. Always use T-hooks inserted in the shipping slots.

**NOTICE:** Towing on a vehicle's drive wheels should be avoided, if possible. When towing on the drive wheels, maximum speed and distance limitations must be adhered to and/or a towing dolly may need to be used.

**NOTICE:** When towing most AWD vehicles, a towing dolly must be used on the ground wheels or vehicle damage will occur.

**NOTICE:** Do not tow with sling-type equipment or the rear bumper valance will be damaged. Use wheel-lift or carrier equipment. Additional ramping may be required for carrier equipment. Use safety chains and wheel straps.

**NOTICE:** Towing a vehicle over rough surfaces could damage the vehicle. Damage can occur from vehicle-to-ground or vehicle-to-wheel-lift equipment contact. Install the towing dolly and raise the vehicle until adequate clearance is obtained between the ground and/or wheel-lift equipment contact.

**NOTICE:** Do not attach winch cables or J-hooks to suspension components when using carrier equipment. Always use T-hooks inserted in the shipping slots.

**NOTICE:** Wheel-lift towing pickup trucks models from the rear while loaded with heavy cargo may cause the frame side rails to flex sufficiently, allowing the pickup box to contact the cab and possibly causing damage to the cab and/or box.