

Inertia switch

In the event of an accident, an inertia switch will trip, isolating fuel pump operation. Once the switch has tripped it must be reset before attempting to restart the engine.

The inertia switch is located behind the trim on the right-hand side of the vehicle, forward of the front door post, below the fascia. Pull open the small panel in the trim to reset the switch.

Resetting the switch



WARNING:

To avoid the possibility of fire or personal injury, do not reset the inertia switch if you see or smell fuel.

If no fuel leak is apparent, reset the inertia switch as follows:

1. Turn the ignition switch to position '0'.
2. Pull open the small panel in the trim.
3. Press down the flexible cover on the top of the inertia switch.
4. Turn the ignition switch to position 'II', pause for a few seconds, then return the key to position '0'.
5. Make a further check for fuel leaks.
6. Close the trim panel.

6-2 Roadside emergency

Emergency starting



WARNING:

1. It will not be possible to push or tow start a vehicle with automatic transmission.
2. Only jump lead starting or the fitting of a fully charged battery is recommended.

Rolling start (manual transmission only)



WARNING:

Because of the dangers to other road users, extreme caution must be exercised when attempting a rolling start.

A rolling start is pushing or towing the vehicle at low speed, in gear (preferably 2nd) with the clutch pedal depressed and the ignition switch in position 'II'.

When sufficient forward speed is obtained, the clutch pedal is gently released and the traction force from the wheels starts the engine.

Emergency starting using jump leads

Both the booster and discharged battery should be treated with great care when using jump leads. Always use high quality leads capable of carrying the starter current of the vehicle to be started.

Before commencing, the following precautions must be taken:

- When the battery of another vehicle is being used, ensure that the vehicles do not touch. Alternatively, remove the charged battery and place near to, not on, the vehicle with the discharged battery.
- Ensure that both vehicles have all electrical services OFF, the parkbrake is ON and, with automatic transmission, 'P' is selected.
- Where the jump leads are of a different colour, e.g. red and black, use red for positive (+). This aids identification and helps to avoid crossing positive (+) to negative (-). Take extra care to avoid crossing the polarity when using cables of the same colour.

Caution:

1. If using a jump start vehicle, under no circumstances should the vehicles come into contact with each other. This could establish an earth connection, which may cause sparks and damage.
2. Do not run the jump start vehicle's engine when boost starting a Jaguar vehicle. If the jump start vehicle's engine is running and the jump leads are disconnected, damage to the Jaguar vehicle's electrical system will result.
3. The booster battery voltage must not exceed 12 volts.

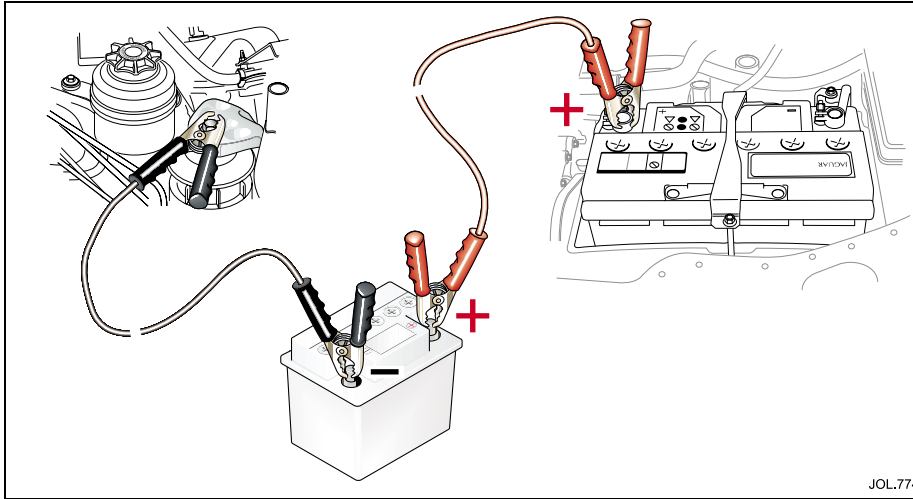

Emergency starting using jump leads (continued)

The following procedure must be followed exactly, being careful not to cause sparks:

1. Apply the parkbrake, select 'P' (automatic transmission vehicles only), and turn off all the vehicle's electrical services.
2. Open the hood to gain access to the battery.

3. Unclip the battery cover.
4. Attach one end of the red jump lead to the positive (+) terminal of the booster battery and the other end to the positive (+) terminal of the discharged battery. Make sure that a good connection is made.

Caution: Do not connect the negative jump lead directly to the negative (-) terminal of the discharged vehicle.

5. Attach one end of the black jump lead to the negative (-) terminal of the booster battery and the other end to the engine mount, as shown. Make sure that a good connection is made.
6. When started, allow the engine to idle for five minutes before disconnecting the cables.
7. Disconnect the black jump lead from the engine mount point and the booster battery negative (-) terminal.
8. Disconnect the red jump lead from the positive (+) terminals of both batteries.
9. Refit the battery box cover.

6-4 Roadside emergency

Wheel changing and jacking

Be prepared for a flat tyre. Know where equipment is stowed and read the wheel changing and jacking instructions carefully. Pull off the road completely, clear of all traffic and park on as level, solid ground as possible. Switch on hazard warning lights and, where legally required, display the warning triangle.



WARNING:

It can be dangerous to change a wheel when the vehicle is on a slope or soft, uneven ground.

The spare wheel and jacking equipment are stored under the luggage compartment floor panel.

To remove the spare wheel, lift the luggage compartment floor panel. If a temporary-use spare wheel is stowed then the tray will need to be removed to gain access to the wheel. Unscrew the retaining nut (A) and remove the spare wheel. Remove the jack and wheel nut wrench (and locking wheel nut kit, if fitted).

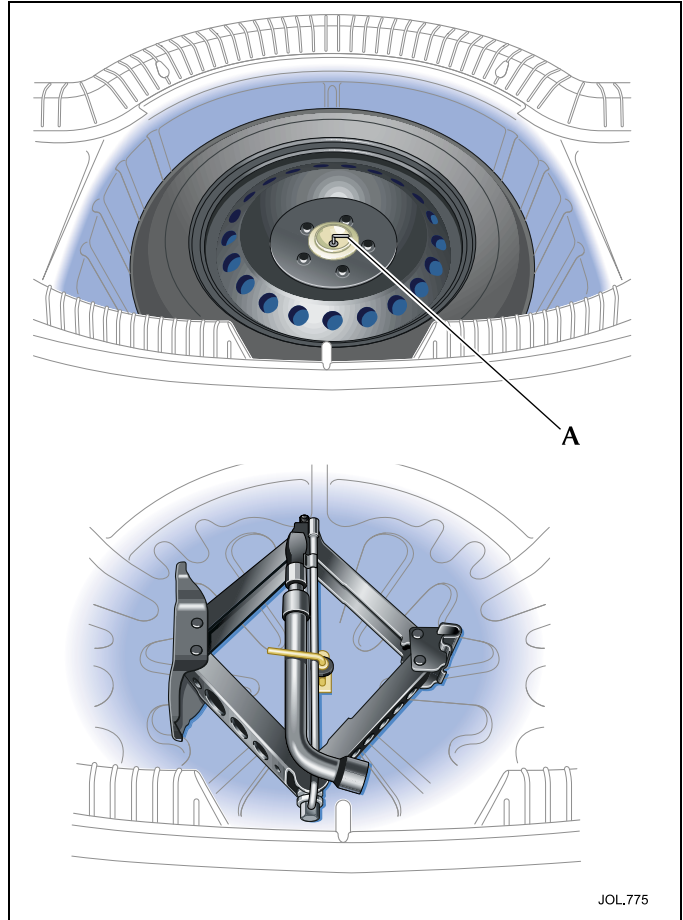

Temporary-use spare wheel

Observe the following warnings before using the wheel.



WARNING:

1. Please note temporary-use spare wheel warning label. Adhere to instructions on the label. Failure to comply can be dangerous.
2. When a temporary-use spare wheel is fitted, drive with caution and replace with the specified wheel and tyre as soon as possible.
3. Do not fit more than one temporary-use spare wheel and tyre assembly at one time.
4. The temporary-use spare wheel must be inflated to the correct pressure. See Section 8.
5. Temporary-use spare wheel, maximum speed is 50 mph (80 km/h).

Note: Maintenance information for the temporary-use spare wheel is the same as given for normal tyres.

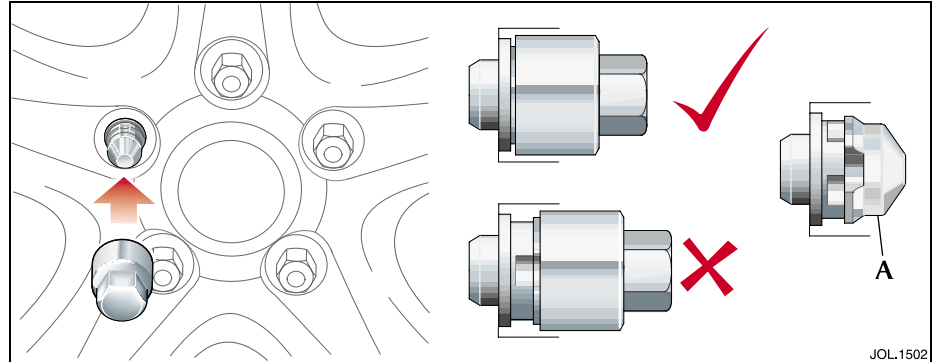

Locking wheel nuts

Where Jaguar locking wheel nuts are fitted (one on each wheel), they can only be removed using the correct key socket.

The locking wheel nut comprises two grooved parts, front and rear, which must be turned together to allow the nut to be fitted or removed.

To remove the nut, the front and rear grooves must be aligned. Locate the key socket in the grooves and push it fully over both parts of the nut. Fit the wheel nut wrench over the key socket and loosen the locking wheel nut.

Attempting to remove the nut without the correct key socket (such as attempted theft) or with the socket not located over the rear part of the nut, will cause the front part only (A) to turn.

If this has happened, rotate the front part with the key socket until the grooves are re-aligned and then push the socket fully over the nut.

Should a new key socket be required, contact your Jaguar Dealer. Proof of vehicle ownership will be required.

6-6 Roadside emergency

Wheel changing

1. Ensure that all passengers are in a safe place, clear of the vehicle.
2. Apply the parkbrake and select gear position 'P' (Park) or select a low gear on a manual transmission vehicle.
3. Ensure that the jack is placed on firm and level ground.

Note: When one rear wheel is lifted off the ground the selection of a low gear on manual vehicles or automatic transmission 'P' (Park) position will not prevent the vehicle from moving and possibly slipping off the jack.



WARNING:

1. **Before attempting to lift the vehicle with the jack, block a wheel diagonally opposite to the wheel being replaced to prevent the vehicle from rolling when jacked up.**
2. **Never work under the vehicle using only the jack as a support, always use axle stands or suitable supports under the jacking points.**

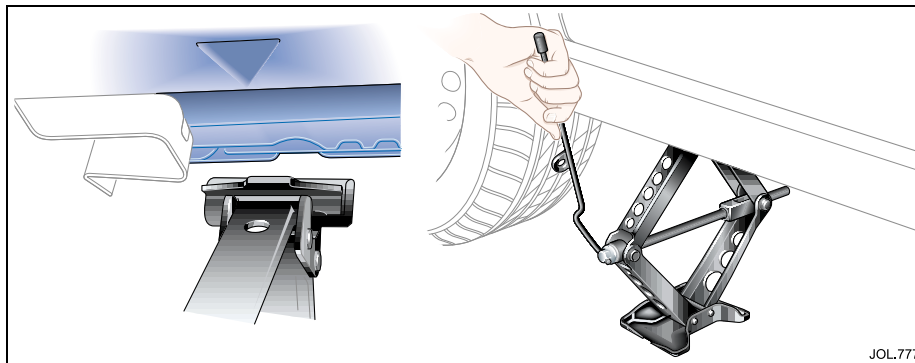

JOL.777

Before raising the vehicle, extend the telescopic wheel nut wrench and slacken, but do not remove the wheel nuts.

Observe the instructions printed on the jack.

Use the jack only for lifting the vehicle during wheel changing, and only use the jack which is stored in the vehicle.

Do not start or run the engine while the vehicle is only supported by a jack.

There are four jacking points, two each side of the vehicle on the underside of the floor. These provide positive location for the jack.

Two indented, triangular jack location points are provided on each sill cover.

The simplest way to correctly locate the jacking point is to feel along the sill panel to the triangular indentation and then fit the jack head to the body flange as shown in the illustration above.

Caution: Ensure that when anyone requires to raise the vehicle that the jack is correctly positioned to avoid any damage to the vehicle sills or sill panels. Use only the correct jacking points, never use bumpers or any other part of the body to lift the vehicle.



WARNING:

1. Do not attempt to lift the vehicle unless the jack head is fully engaged in the jacking point.
2. Ensure that the parkbrake is fully applied.

Place the jack squarely beneath the appropriate jacking point. Ensure that the jack head is fully engaged. Carefully raise the vehicle by turning the handle. Stop jacking the vehicle when the tyre just clears the ground. Minimum tyre lift gives maximum vehicle stability.

Remove the wheel nuts and the wheel.

When changing the alloy road wheels, transfer the centre badge to the replacement wheel (when a full size spare wheel is used). Using the rounded end of the wheel nut wrench handle from the inside of the wheel, push the centre badge from its housing. Push the centre badge into the replacement wheel. If the temporary-use spare wheel is to be fitted, keep the centre badge safely and fit it to the repaired full size wheel when it has been refitted.

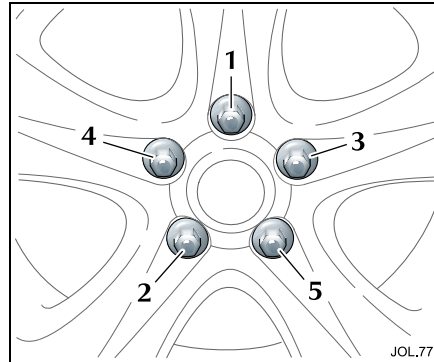

Fit the spare wheel and loosely secure with the wheel nuts.

Using the wheel nut wrench, lightly tighten the wheel nuts alternately using the sequence shown in the illustration.

Lower the jack and tighten the wheel nuts alternately, DO NOT OVERTIGHTEN.

At the earliest opportunity have the wheel nuts tightened with a torque wrench to:

Alloy wheels:

- 75.95 lb.ft. \pm 11.4 (103 Nm \pm 15.5)

Steel wheels:

- 59.0 lb.ft. \pm 8.5 (80 Nm \pm 12.0)

These torque figures must not be exceeded.

Stowing the equipment

Stow the jack and wrench.

Stow the replaced road wheel in the luggage compartment and secure with the retaining nut.

Reposition the luggage compartment floor panel.

Note: Examine the jack occasionally and clean and grease the threads to ensure it is always ready for an emergency.



WARNING:

When the temporary-use spare wheel has been fitted, drive with caution and replace with the specified wheel and tyre as soon as possible.

6-8 Roadside emergency

Vehicle recovery

The recommended vehicle recovery method is by using a flat bed transporter.

Carrying the vehicle on a transporter

When the vehicle is being transported on a flat bed transporter or trailer, apply the parkbrake and select gear position 'N' or 'D' but **NEVER 'P'**. On manual transmissions, select the neutral position.

The vehicle must be securely tied down to the transporter or trailer with the wheels chocked. There are four transporter tie-down brackets on the vehicle underbody. Do not attach tie-down hooks to the towing eye.

Suspended towing

Ensure that the recovery team do not tow with sling-type equipment since damage to the bodywork may result.

Caution: This vehicle has an all wheel drive (AWD) transmission system. Do **NOT** tow the vehicle with the front wheels lifted unless the propshaft to the rear wheels is disconnected at the final drive flange. If the propshaft is not disconnected, the rotating rear wheels will force the front wheels to rotate, even with the gear selector in neutral. Ensure the propshaft is supported.

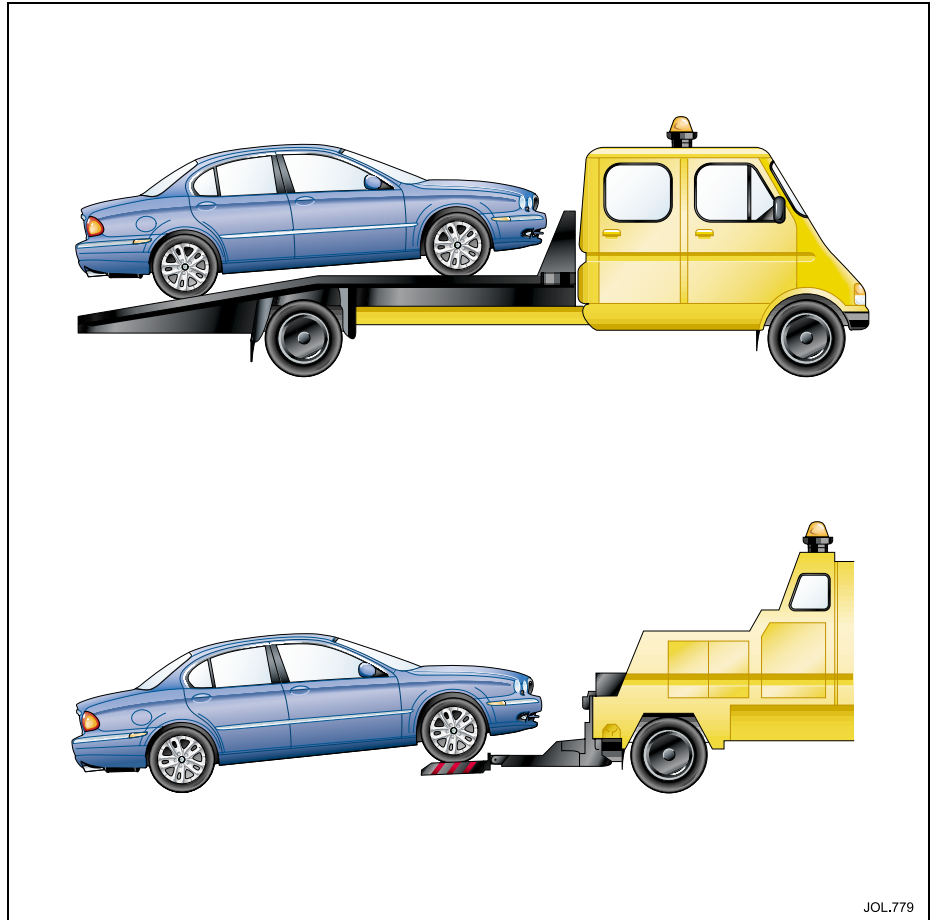

Emergency towing with the vehicle on all four wheels

The removable towing eye (see page 6-10) is primarily for emergency use when towing for SHORT DISTANCES, e.g. removing the vehicle if it is causing an obstruction or for winching the vehicle onto a recovery transporter.

Always obey towing regulations.

In certain countries the registration number of the towing vehicle and an 'ON TOW' sign or warning triangle must be displayed in a prominent position at the rear of the vehicle being towed.

When being towed:

- The parkbrake must be off.
- The vehicle's gear selector lever must be in position 'N' (automatic transmission) or neutral position (manual transmission).
- The ignition key must be turned to position 'II' to release the steering lock and render the indicators, horn and brake lights operational.

Caution:

- To prevent damage to the automatic transmission, towing distance must be restricted to 0.5 miles (0.8 km). Towing speed must not exceed 30 mph (50 km/h).
- Vehicles with manual transmission can be towed, provided there is no damage to the transmission, for a maximum distance of 30 miles (50 km) with the speed not exceeding 30 mph (50 km/h).



WARNING:

When the engine is not running the steering and brakes will no longer be power assisted. Therefore, be prepared for relatively heavy steering and the need for greatly increased brake pedal pressure.

6-10 Roadside emergency

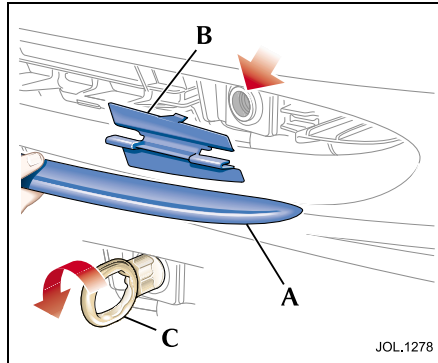

Towing eye

A screw-in towing eye is provided in the luggage compartment with the jack and can be fitted to the front or rear of the vehicle. The towing eye has a left-hand thread and must be turned in an anticlockwise direction when fitting.

Caution:

1. The towing eye is not suitable for 'solid bar' towing.
2. Care must be taken to avoid damaging the bumpers and front apron.

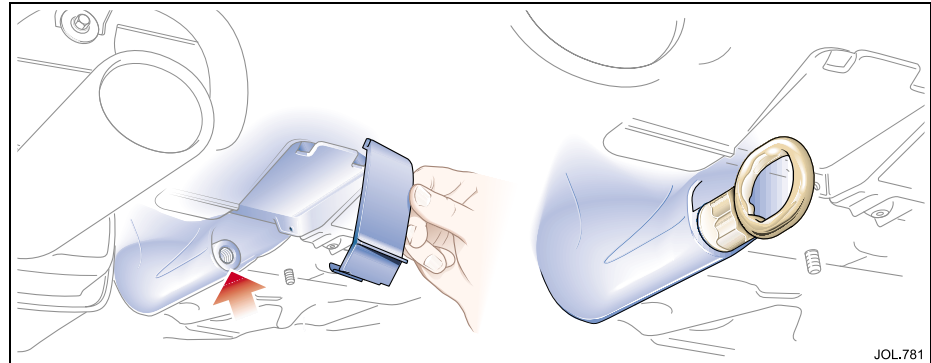

Front tow point

The front towing point is located behind the bumper cover air intake at the right-hand side of the vehicle (as viewed from the front). To access the towing point, the splitter vane and a small cover must be removed. Both items are of the clip on/clip off type.

Pull the splitter vane (A) to remove it from the vehicle.

Pull off the tow point cover (B).

Screw the towing eye (C) into the vehicle, right up to the shoulder.

After removal of the towing eye, carefully press in the cover and splitter vane until they clip into position.

Rear tow point



WARNING:
Avoid body contact with a hot exhaust pipe when fitting the eye to the rear towing point.

The rear towing point is alongside the left-hand exhaust pipe.

Remove the small cover from the bumper. Remove the bung and screw the towing eye into the vehicle, right up to the shoulder.