

# Vehicle recovery

## TOWING POINTS

### Front and rear towing eyes and lashing points

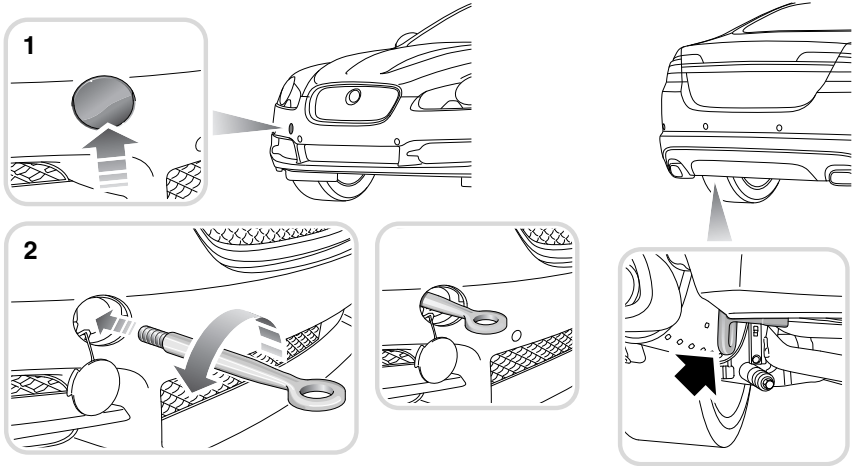

E95301

### WARNINGS



The towing eyes at the front and rear of the vehicle are designed for on-road recovery only. If they are used for any purpose other than those indicated, it may result in vehicle damage and serious injury.



Never use the towing eyes to tow a trailer, caravan etc. Doing so may result in vehicle damage and serious injury.

### CAUTION



Only use the lashing points indicated, or over-tire tie-downs, to secure the vehicle to the transporter or trailer. Use of any other position (e.g. lower control arms) may result in damage to the vehicle.

The front and rear towing eyes are the only recommended lashing points on the vehicle.

### Attaching the front towing eye

The front towing eye is included in the tool kit, located in the under-floor area of the luggage compartment. See **TOOL KIT** (page 209).

1. Press the lower edge of the towing eye cover in the front bumper to open, then pull from the aperture, allowing the cover to hang from its retaining strap.
2. Locate the towing eye through the bumper and screw the towing eye counter-clockwise into its fixing, until secure.

# Vehicle recovery

## TRANSPORTING THE VEHICLE

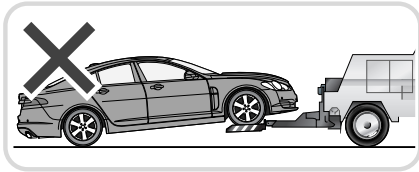
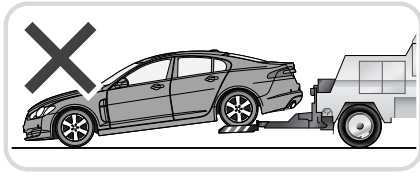
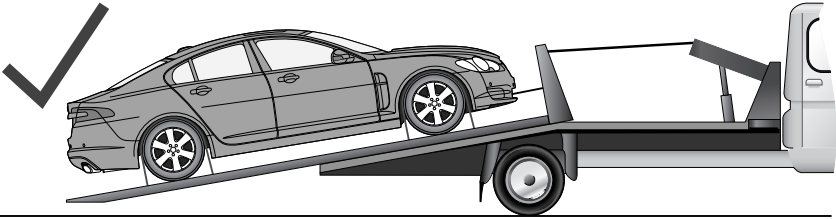

E95304

The recommended method for recovery/transportation of the vehicle, is on a transporter or trailer designed for that purpose.

Ensure that transportation is carried out by suitably qualified persons, and that the vehicle is secured correctly.

If the vehicle is being transported on a trailer or vehicle flat-bed transporter, the parking brake must be applied, the wheels are chocked and the Emergency Park Release (EPR) operated, to ensure that the transmission remains in **N** and does not automatically select **P**.

### Emergency Park Release (EPR)

When recovering your vehicle, it is essential that the EPR is operated. EPR prevents the transmission from automatically selecting **P**, ensuring that the transmission remains in neutral (**N**). EPR is operated by a lever located behind a trim panel in the cubby box. Before activating the EPR, select **P**, apply the parking brake and turn the ignition off.

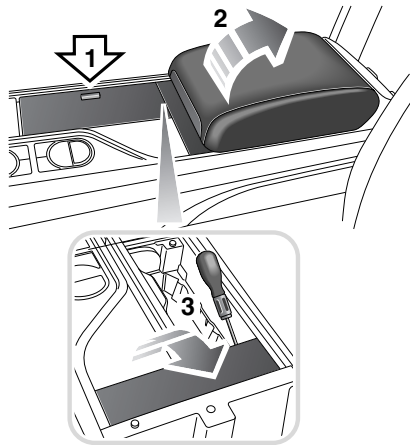

E96407

1. Open the twin cup holder lid.
2. Open the cubby box lid.
3. Using a flat-bladed screwdriver, lever the trim panel upwards (at the point indicated) to release and remove.

# Vehicle recovery

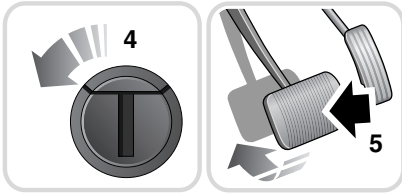
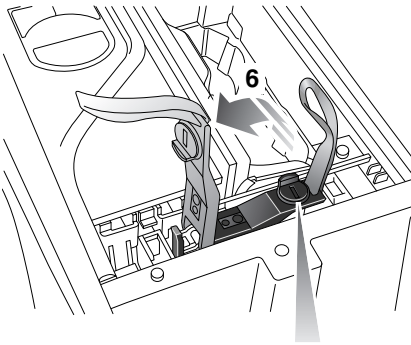

E96408

4. Using a flat-bladed screwdriver, turn the locking device 90° counter-clockwise.
5. Apply the foot brake.
6. Use the strap to pull the EPR lever upwards, until it latches in the vertical position.

When EPR is activated, the JaguarDrive selector will remain in **P**, but the selector indicator and the gear display in the message center will both flash **N** (if ignition is on), to indicate that EPR is active.

When vehicle transportation has been completed, EPR should be cancelled, to allow Park to be re-engaged.

## Cancelling EPR

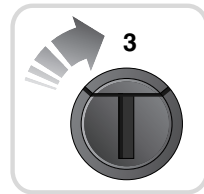
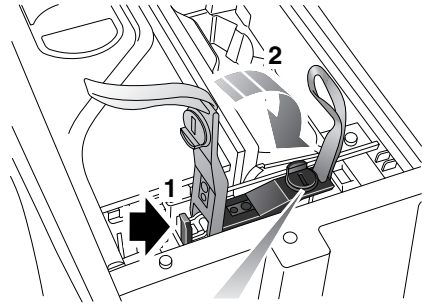

E96409

1. Using a flat-bladed screwdriver, release the latch (arrowed).
2. Return the EPR lever to its horizontal position.
3. Turn the locking device 90° clockwise to secure.
4. Replace the trim panel and close the cubby box and twin cup holder lids.

# Vehicle recovery

## TOWING THE VEHICLE ON FOUR WHEELS

### WARNINGS



Ensure that the remote control remains docked whilst the vehicle is being towed. Removing the remote control will engage the steering lock, which will prevent the vehicle from steering correctly.



If the engine cannot be run whilst the vehicle is being towed, there will be no power assistance for the steering or brakes. This will result in greater effort being required to steer or slow the vehicle, and greatly increased stopping distances.

### CAUTIONS



The vehicle should only be towed in a forward direction with all four wheels on the ground.



The vehicle should only be towed for a maximum of 0.8 km (0.5 miles), at a maximum speed of 48 km/h (30 mph). Towing for a greater distance or at a higher speed, may result in serious damage to the transmission.

**Note:** *The recommended recovery method is to raise all four wheels.*

### Towing procedure

1. The vehicle should be parked on firm level ground, with the parking brake on, and the gear selector in **P** (Park).
2. Secure the towing attachment from the recovery vehicle to the front towing eye. See **TOWING POINTS** (page 235).
3. Dock the Jaguar Smart Key and switch on the ignition. See **GENERAL INFORMATION** (page 129).

### CAUTION



Leaving the ignition switched on for extended periods will cause the battery to drain.

4. Apply the foot brake and release the parking brake.
5. With the foot brake still applied, activate the Emergency Park Release (EPR). See **TRANSPORTING THE VEHICLE** (page 236).
6. The vehicle can now be towed a maximum of 0.8 km (0.5 miles) at a maximum speed of 48 km/h (30 mph).
7. Upon arrival at the destination, ensure wherever possible that the vehicle is parked on firm level ground.
8. Lower the Emergency Park Release (EPR) lever, to cancel EPR and to re-engage **P** (Park).
9. Apply the parking brake.
10. Switch off the ignition and remove the Jaguar Smart Key.

### WARNING



Use extreme caution when detaching towing equipment. Vehicle movement is possible which can result in serious injuries.

11. Remove the towing attachment from the towing eye.

# Vehicle battery

## USING BOOSTER CABLES

### WARNINGS



Always wear appropriate eye protection when working with batteries.



During normal use, batteries emit explosive hydrogen gas - ensure sparks and naked lights are kept away from the luggage compartment.



Do not attempt to start the vehicle if the electrolyte in the battery is suspected of being frozen.



Make sure both batteries are of the 12 volt type and that the booster cables have insulated clamps and are approved for use with 12 volt batteries.



Do not disconnect the discharged battery.



Do not connect positive (+) terminals to negative (-) terminals and ensure booster cables are kept away from any moving parts in the engine compartment.



Do not connect a booster cable to the negative (-) terminal of the battery. Always connect to the recommended earthing point.

**Note:** Before connecting booster cables, ensure that the battery connections on the disabled vehicle are correct and that all electrical equipment has been switched off.

1. Connect one end of the positive booster cable to the positive terminal on the donor vehicle's battery.
2. Connect the other end of the positive booster cable to the positive terminal on the disabled vehicle's battery.

3. Connect one end of the negative booster cable to the earth point of the donor vehicle that is recommended for jump starting by the manufacturer.
4. Connect the other end of the negative booster cable to a suitable earth point on the disabled vehicle. The earth point should be at least 0.5 metres (20 inches) away from the battery and as far as possible from any fuel or brake pipes.
  - Check that all cables are clear of any moving components and that all four connections are secure.
5. Start the engine of the donor vehicle, and allow it to idle for a few minutes.
6. Start the engine of the disabled vehicle.
7. Allow both vehicles to idle for two minutes.
8. Switch off the donor vehicle.

### Disconnecting the cables

#### WARNING



To avoid serious injury use extreme caution when removing the booster cables as the engine will be running on the previously disabled vehicle. This means that you may be working close to components which are moving at high speed, carry high voltage, or may be hot.

**Note:** Do not switch on any electrical equipment until after the cables have been disconnected.

The engine should be running on the previously disabled vehicle and the engine switched off on the donor vehicle. Disconnect the booster cables in the exact reverse order of that used for connection.

# Wheels and tires

## TOOL KIT

### Tool kit contents

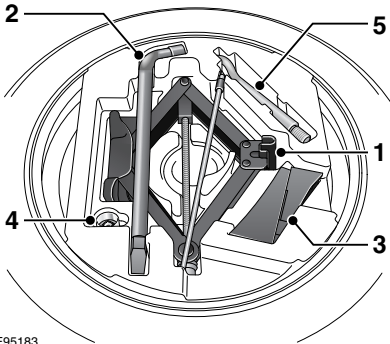

E95183

1. Jack.
2. Wheel brace.
3. Chock.
4. Locking wheel nut adaptor.
5. Towing eye.

### WARNING



After use, the tool kit should be returned to the under floor storage area and correctly stowed. Do not leave the tool kit or its components loose in the storage area, as they can prove hazardous during an impact or sudden manoeuvre.

**Note:** When returning the tool kit to its stowage position, hook the T-bar of the clamp over the jack handle, to secure in position.

**Note:** The jack requires occasional maintenance. Examine the jack for wear, damage or corrosion and lubricate the moving parts.

## CHANGING A ROAD WHEEL

### WARNINGS



Always ensure replacement tires have the correct rating and specifications (e.g. load index, size, speed rating) for your vehicle.



When using tires other than those recommended by Jaguar, do not exceed the speed capacity recommended by the manufacturer.



Wheels are extremely heavy. Take care when lifting and particularly when removing and replacing a wheel in its storage position in the luggage compartment.

If a wheel change is required, pull off the road completely. Park on ground which is as level and solid as possible. Ensure that the vehicle is clear of any objects that will obstruct the safe removal of the wheel. Switch on hazard warning lamps and, where legally required, display the warning triangle.

Regular maintenance of tires contributes not only to safety, but to the designed function of the vehicle. Road-holding, steering and braking are especially vulnerable to incorrectly pressurised, badly fitted or worn tires.

Tires of the correct size and type, but of different make can have widely varying characteristics. It is therefore recommended that Jaguar approved tires are fitted to all wheels.

# Wheels and tires

## Temporary use spare wheel

Observe the following warnings before using the wheel:

### WARNINGS



Note the temporary use spare wheel warning label. Adhere to instructions on the label. Failure to comply can be dangerous.



When a temporary use spare wheel is fitted, drive with caution and replace with the specified wheel and tire as soon as possible.



Do not fit more than one temporary use spare wheel and tire assembly at one time.



The temporary use spare wheel must be inflated to 4.2 bar (60 lbf/in<sup>2</sup>, 420 kPa) and cannot be repaired.



Temporary use spare wheel, maximum speed is 80 km/h (50 mph).



If the vehicle is fitted with Tire Pressure Monitoring System (TPMS). See **TIRE PRESSURE MONITORING SYSTEM** (page 214).



DSC must be **on** when the temporary use spare wheel is in use.

## Locking wheel nuts

Vehicles may be equipped with a locking wheel nut on each wheel. These are similar to standard wheel nuts, and can only be removed using the special adaptor provided with the jacking equipment.

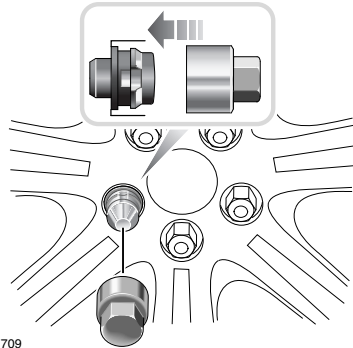

E91709

1. Insert the adaptor firmly onto the locking wheel nut.
2. Using the wheel brace, unscrew the wheel nut and adaptor.
3. Return the locking wheel nut adaptor to the correct storage position.

**Note:** A code number is stamped on the side of the locking nut. Ensure the number is recorded on the Security Card supplied with the literature pack. Quote this number if a replacement is required. Do not keep the Security Card in the vehicle.

# Wheels and tires

## Spare wheel location

The spare wheel and jacking tools are stored under the luggage compartment floor panel.

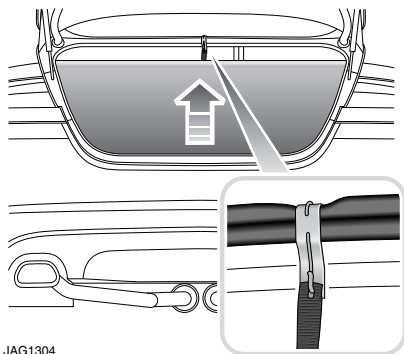

JAG1304

To remove the spare wheel: Raise the luggage compartment floor panel, hooking the strap over the upper boot seal as illustrated.

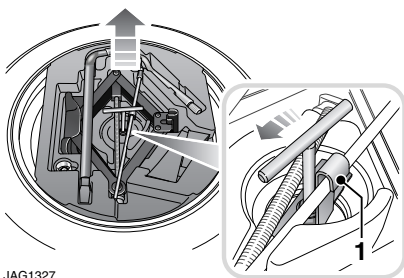

JAG1327

Unscrew the Tee bolt, releasing the retaining clamp and hook.

Remove the tool tray from the spare wheel and remove the spare wheel from the luggage compartment.

Remove the jack and wheel nut wrench from the tray.

**Note:** When refitting the Tee bolt, ensure that the retaining hook (1) fits over the jack handle, as illustrated.

## Wheel changing safety

Before raising the vehicle, or changing a wheel ensure that you read, and comply with the following warnings.

### WARNINGS

-  Always find a safe place to stop, off the highway and away from traffic.
-  Ensure that the vehicle is on firm level ground.
-  Disconnect trailer/caravan from vehicle.
-  Switch on the hazard warning lamps.
-  Ensure that all passengers, and animals, are out of the vehicle and in a safe place away from the highway.
-  Place a warning triangle at a suitable distance behind the vehicle, facing towards oncoming traffic.
-  Ensure that the front wheels are in the straight ahead position, and engage the steering lock.
-  Apply the parking brake, and engage Park (P).
-  Ensure that the jack is on firm level ground.
-  Never place anything between the jack and the ground, or the jack and the vehicle.
-  When one rear wheel is lifted off the ground the selection **P** (Park) position will not prevent the vehicle from moving and possibly slipping off the jack as the park brake only operates on the rear wheels.
-  Do not start or run the engine while the vehicle is supported only by a jack.



# Wheels and tires

---

## WARNINGS



The jack is designed for use when changing a wheel only. Never work beneath the vehicle with the jack as the only means of support - use vehicle support stands.



Always chock the wheel diagonally opposite the wheel to be changed, using the wheel chock supplied in the tool kit. Chock the front of a front wheel, or the rear of a rear wheel.



If jacking the vehicle on a slight slope is unavoidable, place chocks on the downhill side of the two opposite wheels. An additional chock will be needed.



Take care when lifting the spare wheel, and removing the punctured wheel. The wheels are heavy, and can cause injuries if not handled correctly.



Remove the spare wheel prior to jacking the vehicle. To avoid destabilising the vehicle when raised.



Take care when loosening the wheel nuts. The wheel brace may slip off if not properly attached, and the wheel nuts may give way suddenly. Either unexpected movement may cause an injury.

---

## Wheel changing procedure

### WARNINGS



Do not attempt to lift the vehicle unless the jack head is fully engaged in the jacking point.



Ensure that the park brake is applied.

---

### CAUTION



Ensure before raising the vehicle that the jack is correctly positioned to avoid any damage to the vehicle sills or sill panels.

1. Ensure that all passengers are in a safe place, clear of the vehicle.
2. Apply the parking brake and select gear position **P** (Park).
3. Ensure that the jack is placed on firm and level ground.

Observe the instructions printed on the jack.

Use the jack only for lifting the vehicle during wheel changing and only use the jack which is stored in the vehicle.

Before raising the vehicle slacken but do not remove the wheel nuts.

# Wheels and tires

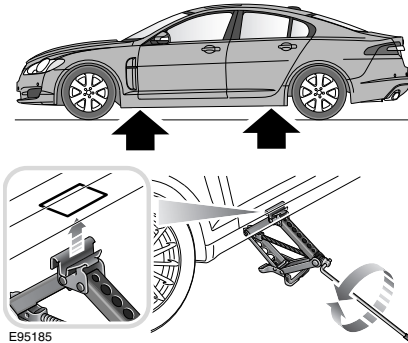

There are four jacking points on the underside of the floor. Two indented, triangular indicators are provided on each sill cover. These indicate the location for the jack.

The simplest way to correctly locate the jacking point is to feel along the sill panel to the triangular indentation and then fit the jack to the body, not to the sill panel.

Carefully raise the vehicle by turning the jack handle. Stop jacking the vehicle when the tire just clears the ground. Minimum tire lift gives maximum vehicle stability.

Remove the wheel nuts and the wheel.

To remove the center badge use the plastic tipped end of the wheel nut wrench handle, push the center badge from its housing from the inside of the wheel.

Push the center badge into the replacement wheel. If the temporary use spare wheel is to be fitted, keep the center badge safely and fit it to the repaired full size wheel when it has been refitted.

Fit the spare wheel and loosely secure with the wheel nuts.

## Tightening the wheel nuts

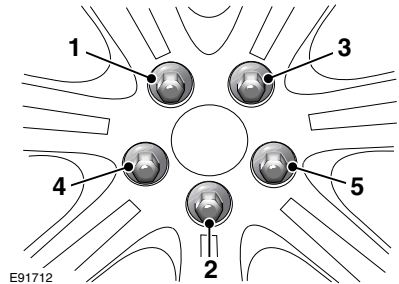

Using the wheel nut wrench, lightly tighten the wheel nuts alternately using the sequence shown in the illustration.

Lower the jack and tighten the wheel nuts alternately. Do not overtighten by using foot pressure or extension bars on the wheel nut wrench.

At the earliest opportunity have the wheel nuts tightened with a torque wrench to 125 Nm (92 lb.ft).

This torque must not be exceeded.